

Series SP

Speed Controller with One-Touch Fittings Direct Connection Type



FEATURES

- Excellent air flow characteristics because of easy fine adjustment of air flow is easy.
- Nylon tube and urethane tube can be used in common.
- Easy control of air flow speed and rate.
- Easy set up of connecting direction.
- Seal treated screw makes operation simple (Screw coated with CHEMI Seal).
- Sleeve color makes application clear.

How to Order

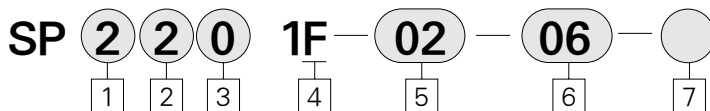

1 Body Size

- 1 : M5
- 2 : 1/8, 1/4
- 3 : 3/8
- 4 : 1/2

2 Type

- 2 : Elbow

3 Controlled Method

- 0 : Meter-out
- 1 : Meter-in

4 With One-touch Fittings

5 Port Size

- M5 : M5X0.8
- 01 : R(PT)1/8

02 : R(PT)1/4

03 : R(PT)3/8

04 : R(PT)1/2

6 Applicable Tube O.D.

04 : $\phi 4$

06 : $\phi 6$

08 : $\phi 8$

10 : $\phi 10$

12 : $\phi 12$

7 Option

Blank : Standard Type

N : Sealant

8 Option

Blank : Standard Type

N : Copper-Free

Structures

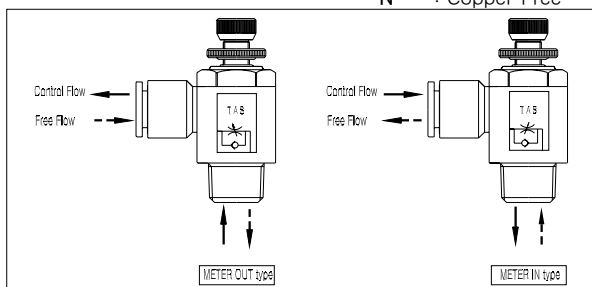
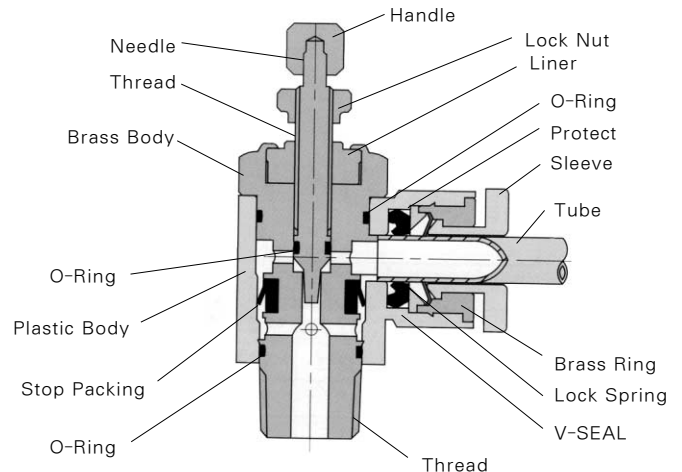

Specifications

Proof Pressure	10.5 kgf/cm ² {1,050 kPa}
Max. Operating Pressure	7 kgf/cm ² {700 kPa}
Min. Operating Pressure	1 kgf/cm ² {100 kPa}
Ambient and Fluid Temperature	5~60°C
Number of Needle Rotation	9 Turns

Dimensions

Elbow Type

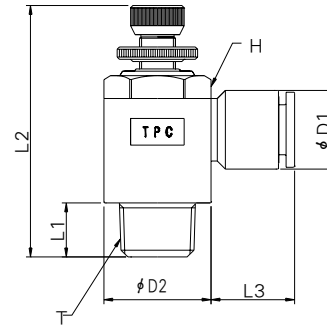

Unit: mm

Model	Tube size	T (Thread)	H	L1	L2		L3	D1	D2
					Min.	Max.			
SP1201F-M5-04	4	M5×0.8	8	4.8	30.4	33.7	14.8	10.2	10
SP1201F-M5-06	6	M5×0.8	8	4.8	30.4	33.7	14.8	12.6	10
SP2201F-01-04S	4	PT1/8	14	8	40.3	46.4	14.3	10.2	15
SP2201F-02-04S	4	PT1/4	17	12.2	45.3	49.4	14.3	10.2	19
SP2201F-01-06S	6	PT1/8	14	8	40.3	46.4	14.8	12.6	15
SP2201F-02-06S	6	PT1/4	17	12.2	45.3	49.4	14.8	12.6	19
SP2201F-01-08S	8	PT1/8	14	8	40.3	46.4	15.9	14.7	15
SP2201F-02-08S	8	PT1/4	17	12.2	45.3	49.4	15.9	14.7	19
SP2201F-02-10S	10	PT1/4	17	12.2	45.3	49.4	18.1	17.6	19
SP3201F-02-06S	6	PT1/4	21	11.6	51.4	57.5	14.8	12.6	19
SP3201F-03-06S	6	PT3/8	21	12.6	52.4	58.5	14.8	12.6	24
SP3201F-02-08S	8	PT1/4	21	11.6	51.4	57.5	15.9	14.7	19
SP3201F-03-08S	8	PT3/8	21	12.6	52.4	58.5	15.9	14.7	24
SP3201F-02-10S	10	PT1/4	21	11.6	51.4	57.5	18.1	17.6	19
SP3201F-03-10S	10	PT3/8	21	12.6	52.4	58.5	18.1	17.6	24
SP3201F-03-12S	12	PT3/8	21	12.6	52.4	58.5	19.1	20	24
SP4201F-04-08S	8	PT1/2	24	15.5	56.3	63.9	15.9	14.7	28
SP4201F-04-10S	10	PT1/2	24	15.5	56.3	63.9	17.3	17.6	28
SP4201F-04-12S	12	PT1/2	24	15.5	56.3	63.9	18.3	20	28

SQ

SP

SPM

ST

SN

SF

USF

TPC

Speed Controller

Structures

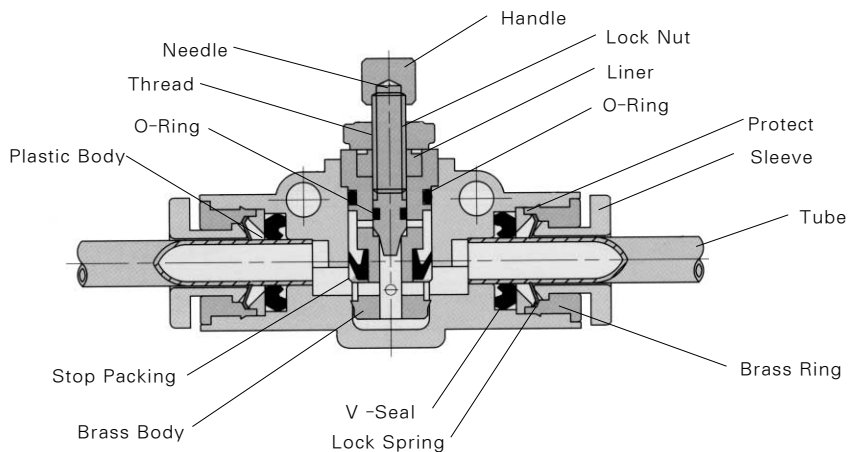

Dimensions

SP Type

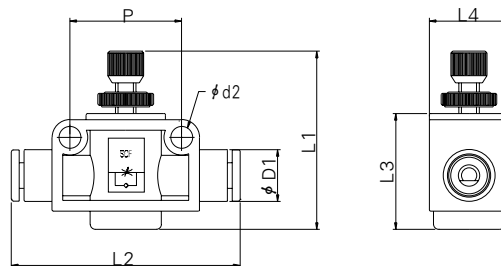

Unit: mm

Model	Tube size	L1		L2	L3	L4	D1	d2	P
		Min.	Max.						
SP100F-04	4	27.2	30.5	42	17.5	12.6	10.2	3.2	16
SP100F-06	6	27.2	30.5	43	17.5	12.6	12.6	3.2	16
SP200F-04	4	33	39.1	46	22.8	15.6	10.2	4.3	22
SP200F-06	6	33	39.1	46	22.8	15.6	12.6	4.3	22
SP205F-04	4	35.9	40	49.2	25.5	18.8	10.2	4.3	24
SP205F-06	6	35.9	40	50.2	25.5	18.8	12.6	4.3	24
SP205F-08	8	35.9	40	52.4	25.5	18.8	14.7	4.3	24
SP300F-06	6	41.7	47.8	54	29.5	23	12.6	4.3	28
SP300F-08	8	41.7	47.8	56	29.5	23	14.7	4.3	28
SP300F-10	10	41.7	47.8	61	29.5	23	17.6	4.3	28
SP300F-12	12	41.7	47.8	62.4	29.5	23	20	4.3	28