

# SOLENOID VALVE CONNECTORS

# CIRCUIT DIAGRAMS & ACCESSORIES

VALVE CONNECTORS WITH LED'S AND SURGE SUPPRESSION AIDE IN DIAGNOSTICS AND PROTECTION OF EQUIPMENT

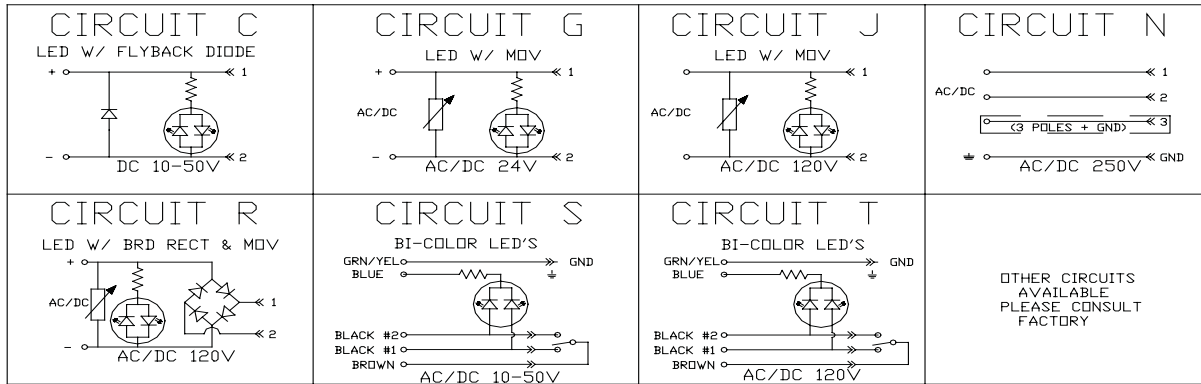

## MALE BASES

ALL CONNECTIONS ARE MADE VIA SOLDER TABS

PART NUMBER: **VMA-020-00**  
 # POLES: 2 + GND  
 MAX COND. SIZE: 16 AWG  
 MAX VOLTAGE: 250 VAC  
 MATERIAL: POLYAMIDE

PART NUMBER: **VMA-030-00**  
 # POLES: 3 + GND  
 MAX COND. SIZE: 16 AWG  
 MAX VOLTAGE: 250 VAC  
 MATERIAL: POLYAMIDE

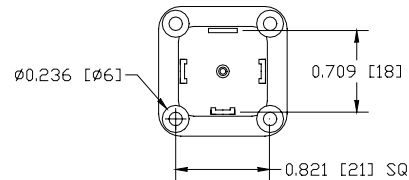
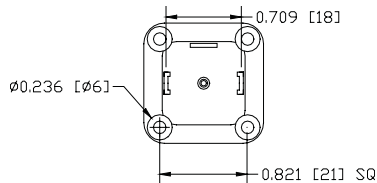

### Thumb Screws:

**MATERIAL:** COPPER ALLOY  
NICKEL PLATED

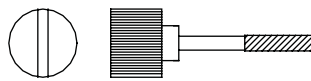

PART NUMBER	FORM STYLE
V-25TB	CABLE VERSION FORM A (VA SERIES) CABLE VERSION FORM B (VB SERIES) CABLE VERSION IND. STD B (VD SERIES) FIELD WIREABLE IND. STD C (VE SERIES)
V-30TB	FIELD WIREABLE FORM A (VA SERIES) FIELD WIREABLE FORM B (VB SERIES) FIELD WIREABLE IND. STD. B (VD SERIES)

### DIN FORM A (VA SERIES) FORMED GASKET

**MATERIAL:** THERMOPLASTIC

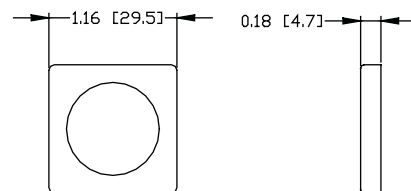

PART NUMBER: **V-GPRA**

ALL VALVE CONNECTORS COME STANDARD WITH MOUNTING SCREW AND FLAT GASKET

VALVE CONNECTORS

# SOLENOID VALVE CONNECTORS

# FIELD WIREABLE

# DIN 43650 FORM A

# OF POLES	VOLTAGE	CIRCUITRY	HOUSING COLOR	FIELD WIREABLE STYLES		
				1/2" NPT FOR CONDUIT	Pg 09 FOR 6mm TO 8mm CABLES	Pg 11 FOR 8mm TO 10mm CABLES
2+ GND	250V AC/DC (MAX)	NONE	GRAY		VFN-029-00	VFN-021-00
			BLACK	VAN-022-00	VAN-029-00	VAN-021-00
3+ GND	250V AC/DC (MAX)	NONE	GRAY		VFN-039-00	VFN-031-00
			BLACK	VAN-032-00	VAN-039-00	VAN-031-00
2+ GND	10-50V DC	LED W/ FLYBACK DIODE	CLEAR	VAC-022-00	VAC-029-00	VAC-021-00
2+ GND	24V AC/DC	LED W/ MOV	CLEAR	VAG-022-00	VAG-029-00	VAG-021-00
2+ GND	120V AC/DC	LED W/ MOV	CLEAR	VAJ-022-00	VAJ-029-00	VAJ-021-00
2+ GND	120V AC/DC	LED W/ BRD RECT, MOV & LED	CLEAR	VAR-022-00	VAR-029-00	VAR-021-00
3+ GND	10-50V AC/DC	2-LED; AMBER & GREEN	CLEAR	NA	VAS-029-00	VAS-021-00
3+ GND	120V AC/DC	2-LED; AMBER & GREEN	CLEAR	NA	VAT-029-00	VAT-021-00

GROUND POSITION NOT APPLICABLE FOR FIELD WIREABLE VERSIONS

### MATERIALS:

**BODY:** POLYAMIDE  
**CONTACT:** COPPER ALLOY  
 SILVER PLATED  
**GASKET:** THERMOPLASTIC  
**SCREW:** STEEL ZINC PLATE  
**TEMPERATURE RANGE:** -40°C TO +125°C  
**PG 09 - 6-8mm**  
**PG 11 - 8-10mm**  
**PROTECTION:** IP 65

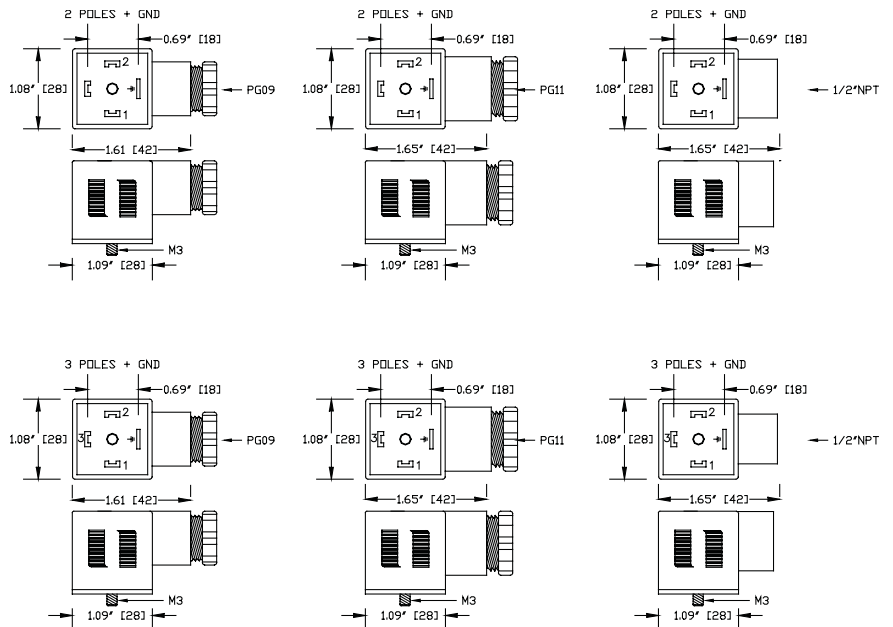

VALVE CONNECTORS

# SOLENOID VALVE CONNECTORS

# CABLED VERSIONS

# DIN 43650 FORM A

# OF POLES	VOLTAGE	CIRCUITRY	PREWIRED VERSIONS		
			2 METERS	5 METERS	10 METERS
2+ GND	250V AC/DC (MAX)	NONE	VAN-220-00	VAN-520-00	VAN-A20-00
3+ GND	250V AC/DC (MAX)	NONE	VAN-230-00	VAN-530-00	VAN-A30-00
2+ GND	10-50V DC	LED W/ FLYBACK DIODE	VAC-220-00	VAC-520-00	VAC-A20-00
2+ GND	24V AC/DC	LED W/ MOV	VAG-220-00	VAG-520-00	VAG-A20-00
2+ GND	120V AC/DC	LED W/ MOV	VAJ-220-00	VAJ-520-00	VAJ-A20-00
2+ GND	120V AC/DC	LED W/ BRD RECT, MOV & LED	VAR-220-00	VAR-520-00	VAR-A20-00
3+ GND	10-50V AC/DC	2-LED; AMBER & GREEN	VAS-230-00	VAS-530-00	VAS-A30-00
3+ GND	120 V AC/DC	2-LED; AMBER & GREEN	VAT-230-00	VAT-530-00	VAT-A30-00

### MATERIALS:

**BODY:** BLACK POLYAMIDE  
**CONTACT:** COPPER ALLOY  
 SILVER PLATED  
**INSERT:** POLYAMIDE  
**GASKET:** THERMOPLASTIC  
**SCREW:** STEEL ZINC PLATE  
**CABLE:** BLACK PVC  
**TEMPERATURE:** -40°C TO +80°C  
**PROTECTION:** IP 65  
**2 POLE:** 3x18 AWG  
**CABLE O.D.** 0.23"  
**3 POLE:** 4x18 AWG  
**CABLE O.D.** 0.26"

VALVE PIN #	COLOR CODE	
	2 + GND	3 + GND
1	BROWN	BROWN
2	BLUE	BLUE
3	NA	BLACK
GROUND	GRN/YEL	GRN/YEL

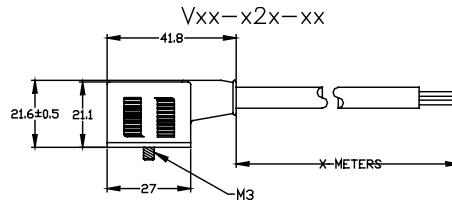

2 POLES + GROUND (DUAL GROUND)

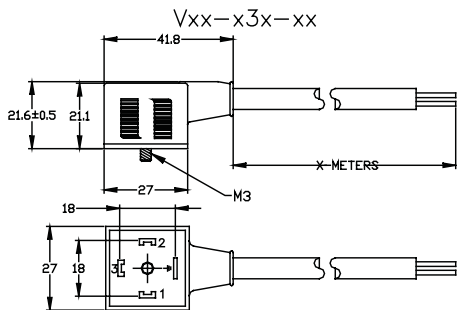

3 POLES + GROUND (GROUND CABLE SIDE)

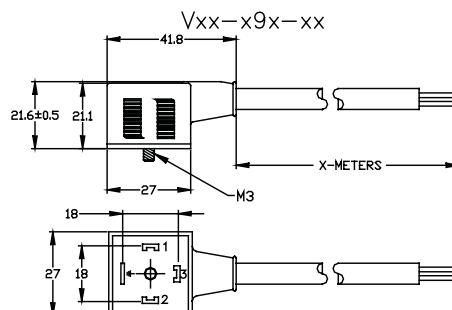

3 POLES + GROUND (GROUND OPPOSITE CABLE SIDE)

VALVE CONNECTORS

# SOLENOID VALVE CONNECTORS

# FIELD WIREABLE & CABLES

# DIN 43650 FORM B

# OF POLES	VOLTAGE	CIRCUITRY	FIELD WIREABLE		PREWIRED STYLES		
			1/2" NPT CONDUIT	PG 9 O.D 6 - 8 mm	2 METERS	5 METERS	10 METERS
2+ GND	250 VAC (MAX)	NONE		VGN-029-00 (GRAY)	VBN-220-00	VBN-520-00	VBN-A20-00
			VBN-022-00	VBN-029-00 (BLACK)			
2+ GND	10-50V DC	LED W/ FLYBACK DIODE	VBC-022-00	VBC-029-00	VBC-220-00	VBC-520-00	VBC-A20-00
2+ GND	24V AC/DC	LED W/ MOV	VBG-022-00	VBG-029-00	VBG-220-00	VBG-520-00	VBG-A20-00
2+ GND	120V AC/DC	LED W/ MOV	VBJ-022-00	VBJ-029-00	VBJ-220-00	VBJ-520-00	VBJ-A20-00

GROUND POSITION NOT APPLICABLE FOR FIELD WIREABLE VERSIONS

**MATERIALS:**

BODY: POLYAMIDE  
 CONTACT: COPPER ALLOY SILVER PLATED  
 GASKET: THERMOPLASTIC  
 SCREW: STEEL ZINC PLATE  
 TEMPERATURE: -40°C TO +80°C  
 PROTECTION: IP 65

VALVE PIN #	COLOR CODE	
	2 + GND	3 + GND
1	BROWN	BROWN
2	BLUE	BLUE
3	NA	BLACK
GROUND	GRN/YEL	GRN/YEL

**FIELD WIREABLE:**

CABLE O.D.: PG 09  
 6-8mm

**CABLE VERSION:**

BODY: BLACK POLYAMIDE  
 CABLE: BLACK PVC  
 2 POLE: 3x18 AWG  
 CABLE O.D.: 0.23"

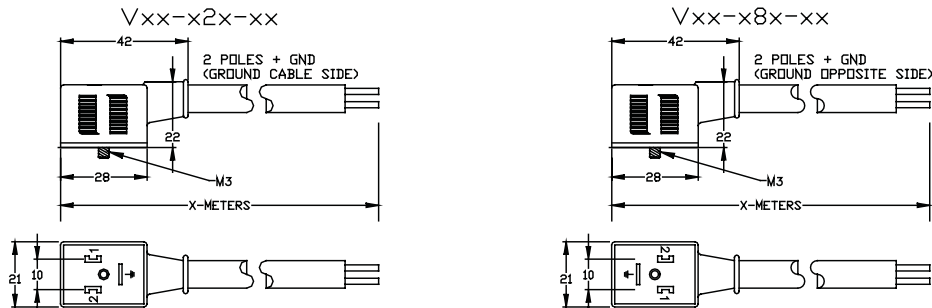
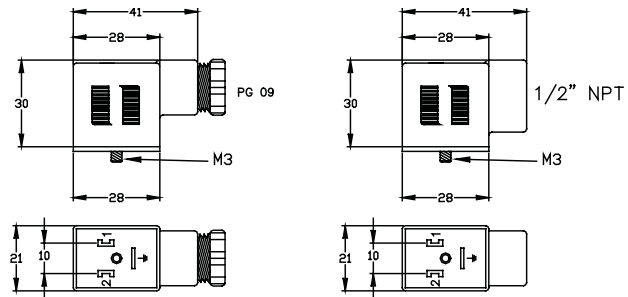

VALVE CONNECTORS

# SOLENOID VALVE CONNECTORS

# FIELD WIREABLE & CABLES

# IND. STD. FORM B

# OF POLES	VOLTAGE	CIRCUITRY	FIELD WIREABLE		PREWIRED STYLES		
			1/2" NPT CONDUIT	PG 9 O.D. 6 - 8 mm	2 METERS	5 METERS	10 METERS
2+ GND	250 VAC (MAX)	NONE		VJN-029-00 (GRAY)	VDN-220-00	VDN-520-00	VDN-A20-00
			VDN-022-00 (BLACK)	VDN-029-00 (BLACK)			
2+ GND	10-50V DC	LED W/ FLYBACK DIODE	VDC-022-00	VDC-029-00	VDC-220-00	VDC-520-00	VDC-A20-00
2+ GND	24V AC/DC	LED W/ MOV	VDG-022-00	VDG-029-00	VDG-220-00	VDG-520-00	VDG-A20-00
2+ GND	120V AC/DC	LED W/ MOV	VDJ-022-00	VDJ-029-00	VDJ-220-00	VDJ-520-00	VDJ-A20-00

GROUND POSITION NOT APPLICABLE FOR FIELD WIREABLE VERSIONS

**MATERIALS:**

**BODY:** POLYAMIDE  
**CONTACT:** COPPER ALLOY  
 SILVER PLATED  
**GASKET:** THERMOPLASTIC  
**SCREW:** STEEL ZINC PLATE  
**TEMPERATURE:** -40°C TO +80°C  
**PROTECTION:** IP 65

VALVE PIN #	COLOR CODE	
	2 + GND	3 + GND
1	BROWN	BROWN
2	BLUE	BLUE
3	NA	BLACK
GROUND	GRN/YEL	GRN/YEL

**FIELD WIREABLE:**

**CABLE O.D.:** PG 09  
 6-8mm

**CABLE VERSION:**

**BODY:** BLACK POLYAMIDE  
**CABLE:** BLACK PVC  
**2 POLE:** 3x18 AWG  
**CABLE O.D.:** 0.23"

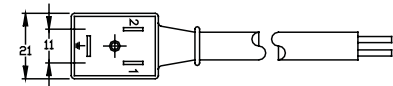
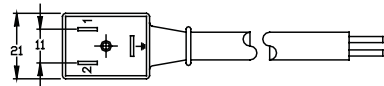
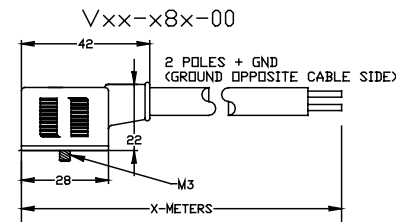
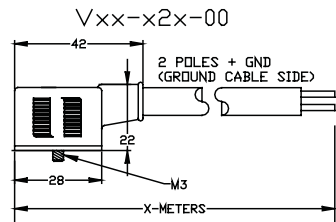
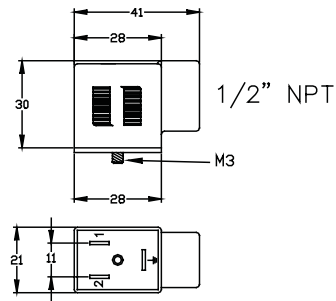
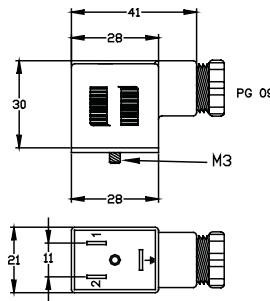

VALVE CONNECTORS

# SOLENOID VALVE CONNECTORS

# FIELD WIREABLE & CABLES

# DIN 43650 FORM C

# OF POLES	VOLTAGE	CIRCUITRY	FIELD WIREABLE	PREWIRED STYLES		
			Pg 07 FOR 6 - 7 mm CABLES	2 METERS	5 METERS	10 METERS
2+ GND	250V AC/DC	NONE	VHN-027-00 (GRAY)	VCN-220-00	VCN-520-00	VCN-A20-00
			VCN-027-00 (BLACK)			
3+ GND	250V AC/DC	NONE	VHN-037-00 (GRAY)	VCN-230-00	VCN-530-00	VCN-A30-00
			VCN-037-00 (BLACK)			
2+ GND	10-50V DC	LED W/ FLYBACK DIODE	VCC-027-00	VCC-220-00	VCC-520-00	VCC-A20-00
2+ GND	24V AC/DC	LED W/ MOV	VCG-027-00	VCG-220-00	VCG-520-00	VCG-A20-00
2+ GND	120V AC/DC	LED W/ MOV	VCJ-027-00	VCJ-220-00	VCJ-520-00	VCJ-A20-00

GROUND POSITION NOT APPLICABLE FOR FIELD WIREABLE VERSIONS

**MATERIALS:**

**BODY:** POLYAMIDE  
**CONTACT:** COPPER ALLOY SILVER PLATED  
**GASKET:** THERMOPLASTIC  
**SCREW:** STEEL ZINC PLATE  
**TEMPERATURE:** -40°C TO +80°C  
**PROTECTION:** IP 65

VALVE PIN #	COLOR CODE	
	2 + GND	3 + GND
1	BROWN	BROWN
2	BLUE	BLUE
3	NA	BLACK
GROUND	GRN/YEL	GRN/YEL

**FIELD WIREABLE:**

**CABLE O.D.:** PG 07  
 6-7mm

**CABLE VERSION:**

**BODY:** BLACK POLYAMIDE  
**CABLE:** BLACK PVC  
**2 POLE:** 3x20 AWG  
**CABLE O.D.:** 0.23"  
**3 POLE:** 3x18 AWG  
**CABLE O.D.:** 0.26"

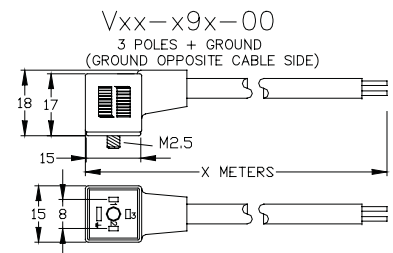
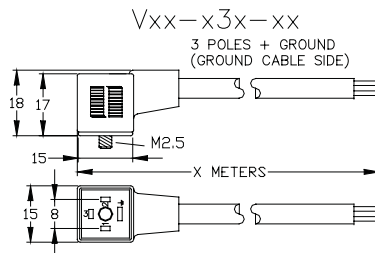
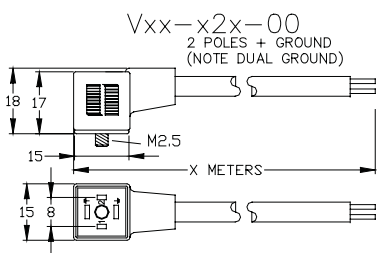
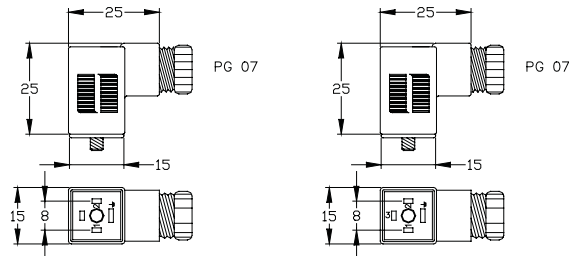

# SOLENOID VALVE CONNECTORS

# FIELD WIREABLE & CABLES

# IND. STD. FORM C

# OF POLES	VOLTAGE	CIRCUITRY	FIELD WIREABLE	PREWIRED STYLES		
			Pg 07 FOR 6 - 7 mm CABLES	2 METERS	5 METERS	10 METERS
2+ GND	250V AC/DC	NONE	VKN-027-00 (GRAY)	VEN-220-00	VEN-520-00	VEN-A20-00
			VEN-027-00 (BLACK)			
3+ GND	250V AC/DC	NONE	VKN-037-00 (GRAY)	VEN-230-00	VEN-530-00	VEN-A30-00
			VEN-037-00 (BLACK)			
2+ GND	10-50V DC	LED W/ FLYBACK DIODE	VEC-027-00	VEC-220-00	VEC-520-00	VEC-A20-00
2+ GND	24V AC/DC	LED W/ MOV	VEG-027-00	VEG-220-00	VEG-520-00	VEG-A20-00
2+ GND	120V AC/DC	LED W/ MOV	VEJ-027-00	VEJ-220-00	VEJ-520-00	VEJ-A20-00

GROUND POSITION NOT APPLICABLE FOR FIELD WIREABLE VERSIONS

**MATERIALS:**

BODY: POLYAMIDE  
 CONTACT: COPPER ALLOY SILVER PLATED  
 GASKET: THERMOPLASTIC  
 SCREW: STEEL ZINC PLATE  
 TEMPERATURE: -40°C TO +80°C  
 PROTECTION: IP 65

VALVE PIN #	COLOR CODE	
	2 + GND	3 + GND
1	BROWN	BROWN
2	BLUE	BLUE
3	NA	BLACK
GROUND	GRN/YEL	GRN/YEL

**FIELD WIREABLE:**

CABLE O.D.: PG 07  
 6-7mm

**CABLE VERSION:**

BODY: BLACK POLYAMIDE  
 CABLE: BLACK PVC  
 2 POLE: 3x20 AWG  
 CABLE O.D.: 0.23"  
 3 POLE: 3x18 AWG  
 CABLE O.D.: 0.26"

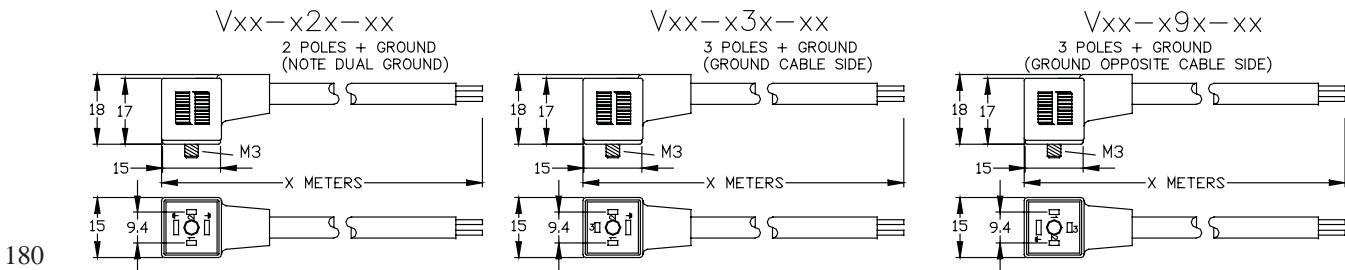
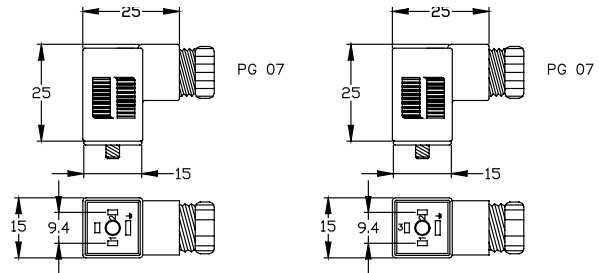

<b>SOLENOID VALVE CONNECTORS</b>	<b>DIN A TO MICRO DC MALE RECEPTACLE</b>	<b>DIN 43650 FORM A TO M12 (MDC)</b>
--	--	--

# OF POLES	VOLTAGE	CIRCUITRY	HOUSING COLOR	M12 (MDC) # POLES	
				4	5
2+ GND	250V AC/DC (MAX)	NONE	GRAY	VFN-029-3401	VFN-029-3501
			BLACK	VAN-029-3401	VAN-029-3501
2+ GND	10-50V DC	LED W/ FLYBACK DIODE	CLEAR	VAC-029-3401	VAC-029-3501
2+ GND	24V AC/DC	LED W/ MOV	CLEAR	VAG-029-3401	VAG-029-3501
2+ GND	120V AC/DC	LED W/ MOV	CLEAR	VAJ-029-3401	VAJ-029-3501
2+ GND	120V AC/DC	LED W/ BRD RECT, MOV & LED	CLEAR	VAR-029-3401	VAR-029-3501

NOTE: GROUND IS NOT CONNECTED ON 4 POLE VERSIONS

**DIN CONNECTOR MATERIALS:**

BODY: POLYAMIDE  
 CONTACT: COPPER ALLOY  
           SILVER PLATED  
 GASKET: THERMOPLASTIC  
 SCREW: STEEL ZINC PLATE  
 TEMPERATURE: -40°C TO +80°C  
 PROTECTION: IP 65

**MDC CONNECTOR MATERIALS:**

BODY: NICKEL PLATED BRASS  
 O-RING: BUNA-N  
 INSULATOR: POLYAMIDE  
 CONTACTS: COPPER ALLOY WITH  
               GOLD PLATING

DIN 43650 FORM A PIN #	M12 (MDC) 4 POLE PIN #	M12 (MDC) 5 POLE PIN #
1	4	4
2	3	3
GND		5
3 NOT USED	1, 2 & 5 NOT USED	1 & 2 NOT USED

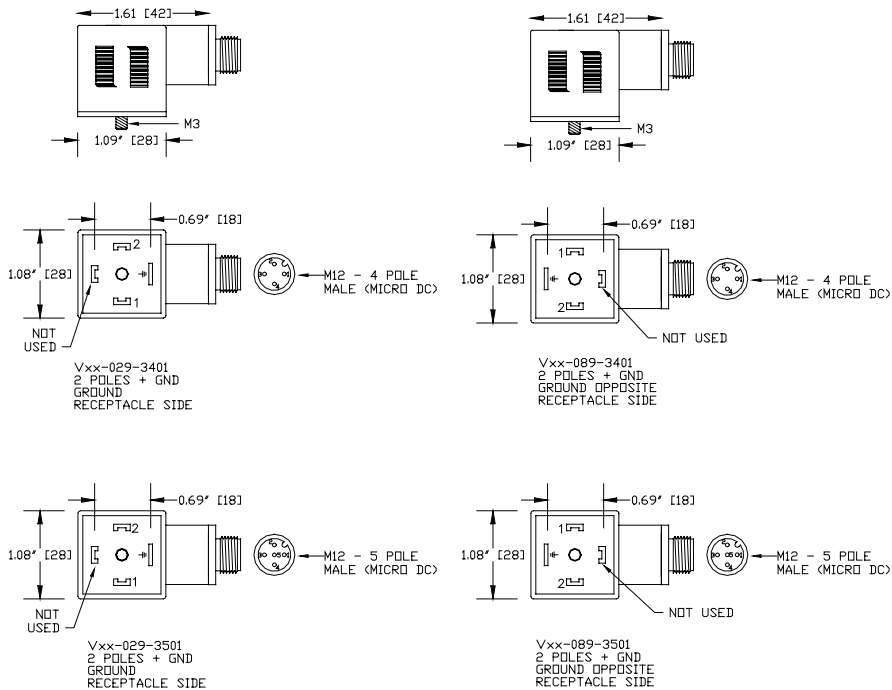

# SOLENOID VALVE CONNECTORS

# DIN A TO MICRO DC 4 POLE MALE CABLE

# DIN 43650 FORM A TO MDC

# OF POLES	VOLTAGE	CIRCUITRY	M12 (MDC) 4 POLE CABLE STRAIGHT MALE			M12 (MDC) 4 POLE CABLE RIGHT ANGLE MALE		
			2 METERS	5 METERS	10 METERS	2 METERS	5 METERS	10 METERS
2+ GND	250V AC/DC (MAX)	NONE	VAN-220-3401	VAN-520-3401	VAN-A20-3401	VAN-220-3402	VAN-520-3402	VAN-A20-3402
2+ GND	10-50V DC	LED W/ FLYBACK DIODE	VAC-220-3401	VAC-520-3401	VAC-A20-3401	VAC-220-3402	VAC-520-3402	VAC-A20-3402
2+ GND	120V AC/DC	LED W/ MOV	VAJ-220-3401	VAJ-520-3401	VAJ-A20-3401	VAJ-220-3402	VAJ-520-3402	VAJ-A20-3402

OTHER CIRCUIT OPTIONS ARE AVAILABLE, CONSULT FACTORY.  
MDC RIGHT ANGLE VERSIONS ARE NON-STOCK ITEMS.

**DIN CONNECTOR MATERIALS:**

BODY: POLYAMIDE  
CONTACT: COPPER ALLOY SILVER PLATED  
GASKET: THERMOPLASTIC  
SCREW: STEEL ZINC PLATE  
TEMPERATURE: -40°C TO +80°C  
PROTECTION: IP 65

**MDC CONNECTOR MATERIALS:**

BODY : NICKEL PLATED BRASS  
O-RING: BUNA-N  
INSULATOR: POLYAMIDE  
CONTACTS: COPPER ALLOY WITH GOLD PLATING

DIN 43650 FORM A PIN #	M12 (MDC) 4 POLE PIN #
1	4
2	3
GND (NOT USED)	1, 2 & 5 (NOT USED)

VALVE CONNECTORS

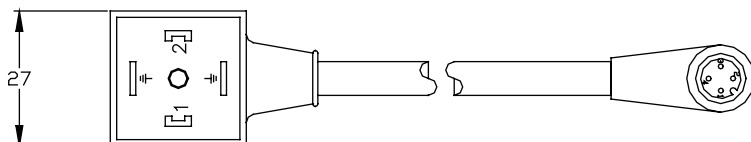
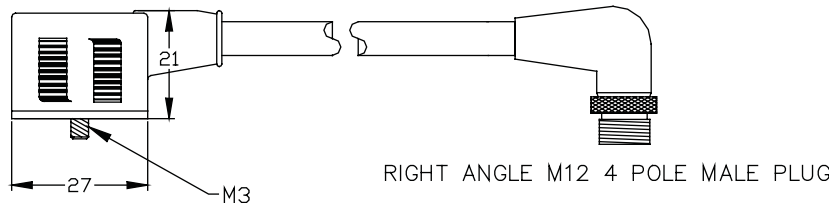
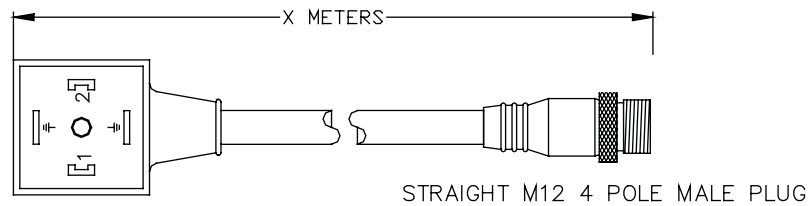

<b>SOLENOID VALVE CONNECTORS</b>	<b>DIN A TO MICRO DC 5 POLE MALE CABLE</b>	<b>DIN 43650 FORM A TO MDC</b>
--	--	--

# OF POLES	VOLTAGE	CIRCUITRY	M12 (MDC) 5 POLE CABLE STRAIGHT MALE			M12 (MDC) 5 POLE CABLE RIGHT ANGLE MALE		
			2 METERS	5 METERS	10 METERS	2 METERS	5 METERS	10 METERS
2+ GND	250V AC/DC (MAX)	NONE	VAN-220-3501	VAN-520-3501	VAN-A20-3501	VAN-220-3502	VAN-520-3502	VAN-A20-3502
2+ GND	10-50V DC	LED W/ FLYBACK DIODE	VAC-220-3501	VAC-520-3501	VAC-A20-3501	VAC-220-3502	VAC-520-3502	VAC-A20-3502
2+ GND	120V AC/DC	LED W/ MOV	VAJ-220-3501	VAJ-520-3501	VAJ-A20-3501	VAJ-220-3502	VAJ-520-3502	VAJ-A20-3502

OTHER CIRCUIT OPTIONS ARE AVAILABLE, CONSULT FACTORY.  
MDC RIGHT ANGLE VERSIONS ARE NON-STOCK ITEMS.

**DIN CONNECTOR MATERIALS:**

BODY: POLYAMIDE  
CONTACT: COPPER ALLOY  
          SILVER PLATED  
GASKET: THERMOPLASTIC  
SCREW: STEEL ZINC PLATE  
TEMPERATURE: -40°C TO +80°C  
PROTECTION: IP 65

**MDC CONNECTOR MATERIALS:**

BODY : NICKEL PLATED BRASS  
O-RING: BUNA-N  
INSULATOR: POLYAMIDE  
CONTACTS: COPPER ALLOY WITH  
              GOLD PLATING

DIN 43650 FORM A PIN #	M12 (MDC) 5 POLE PIN #
1	4
2	3
GND	5
	1 & 2 (NOT USED)

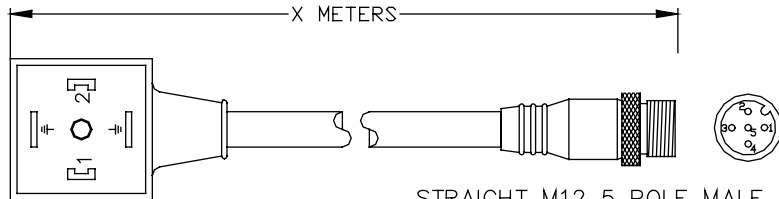

STRAIGHT M12 5 POLE MALE PLUG

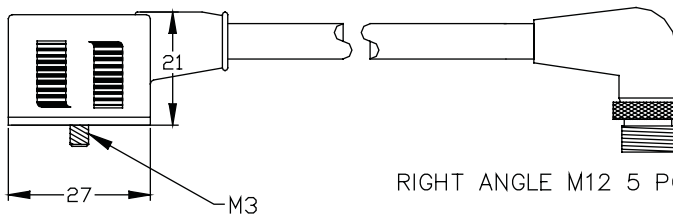

RIGHT ANGLE M12 5 POLE MALE PLUG

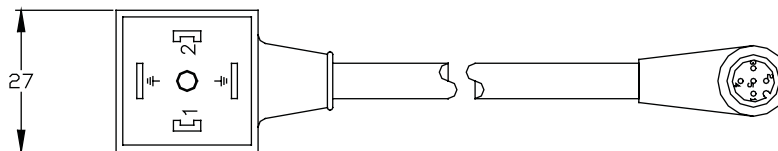

# SOLENOID VALVE CONNECTORS

# IND. STD B TO MICRO DC MALE RECEPTACLE

# IND. STD. FORM B TO MDC

# OF POLES	VOLTAGE	CIRCUITRY	HOUSING COLOR	M12 (MDC) # POLES	
				4	5
2+ GND	250V AC/DC (MAX)	NONE	GRAY	VJN-029-3401	VJN-029-3501
			BLACK	VDN-029-3401	VDN-029-3501
2+ GND	10-50V DC	LED W/ FLYBACK DIODE	CLEAR	VDC-029-3401	VDC-029-3501
2+ GND	24V AC/DC	LED W/ MOV	CLEAR	VDG-029-3401	VDG-029-3501
2+ GND	120V AC/DC	LED W/ MOV	CLEAR	VDJ-029-3401	VDJ-029-3501

OTHER CIRCUIT OPTIONS ARE AVAILABLE; CONSULT FACTORY.

**DIN CONNECTOR MATERIALS:** POLYAMIDE

**CONTACT:** COPPER ALLOY  
**GASKET:** THERMOPLASTIC  
**SCREW:** STEEL ZINC PLATE  
**TEMPERATURE:** -40°C TO +80°C

**BODY :** NICKEL PLATED BRASS  
**O-RING:** BUNA-N  
**INSULATOR:** POLYAMIDE  
**CONTACTS:** COPPER ALLOY WITH GOLD PLATING

DIN 43650 I. S. B. PIN #	M12 (MDC) 4 POLE PIN #	M12 (MDC) 5 POLE PIN #
1	4	4
2	3	3
GND	NOT USED	5
	1,2 & 5 (NOT USED)	1 & 2 (NOT USED)

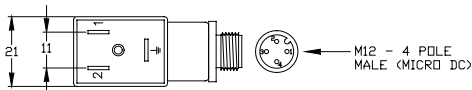
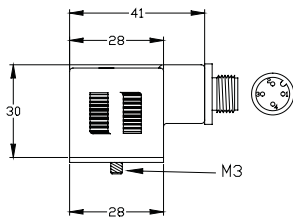

Vxx-029-3401  
GROUND TOWARD  
RECEPTACLE SIDE

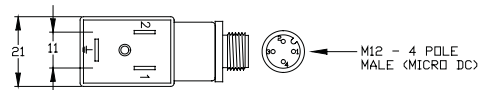
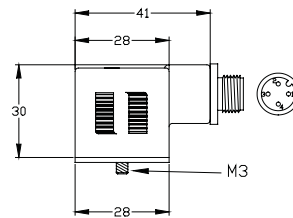

Vxx-089-3401  
GROUND OPPOSITE  
RECEPTACLE SIDE

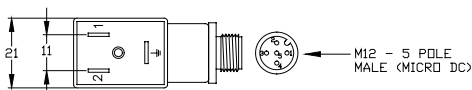

Vxx-029-3501  
GROUND TOWARD  
RECEPTACLE SIDE

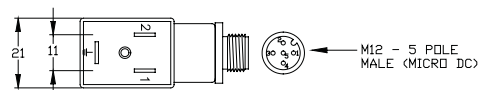

Vxx-089-3501  
GROUND OPPOSITE  
RECEPTACLE SIDE

<b>SOLENOID VALVE CONNECTORS</b>	<b>IND. STD B TO MICRO DC MALE CABLE</b>	<b>IND. STD. FORM B TO MDC</b>
--	--	--

# OF POLES	VOLTAGE	CIRCUITRY	M12 (MDC) 4 POLE CABLE STRAIGHT MALE			M12 (MDC) 4 POLE CABLE RIGHT ANGLE MALE		
			2 METERS	5 METERS	10 METERS	2 METERS	5 METERS	10 METERS
2+ GND	250V AC/DC (MAX)	NONE	VDN-220-3401	VDN-520-3401	VDN-A20-3401	VDN-220-3402	VDN-520-3402	VDN-A20-3402
2+ GND	10-50V DC	LED W/ FLYBACK DIODE	VDC-220-3401	VDC-520-3401	VDC-A20-3401	VDC-220-3402	VDC-520-3402	VDC-A20-3402
2+ GND	120V AC/DC	LED W/ MOV	VDJ-220-3401	VDJ-520-3401	VDJ-A20-3401	VDJ-220-3402	VDJ-520-3402	VDJ-A20-3402

# OF POLES	VOLTAGE	CIRCUITRY	M12 (MDC) 5 POLE CABLE STRAIGHT MALE			M12 (MDC) 5 POLE CABLE RIGHT ANGLE MALE		
			2 METERS	5 METERS	10 METERS	2 METERS	5 METERS	10 METERS
2+ GND	250V AC/DC (MAX)	NONE	VDN-220-3501	VDN-520-3501	VDN-A20-3501	VDN-220-3502	VDN-520-3502	VDN-A20-3502
2+ GND	10-50V DC	LED W/ FLYBACK DIODE	VDC-220-3501	VDC-520-3501	VDC-A20-3501	VDC-220-3502	VDC-520-3502	VDC-A20-3502
2+ GND	120V AC/DC	LED W/ MOV	VDJ-220-3501	VDJ-520-3501	VDJ-A20-3501	VDJ-220-3502	VDJ-520-3502	VDJ-A20-3502

**DIN CONNECTOR MATERIALS:**

BODY: POLYAMIDE  
 CONTACT: COPPER ALLOY SILVER PLATED  
 GASKET: THERMOPLASTIC  
 SCREW: STEEL ZINC PLATE  
 TEMPERATURE: -40°C TO +80°C  
 PROTECTION: IP 65

**MDC CONNECTOR MATERIALS:**

BODY : NICKEL PLATED BRASS  
 O-RING: BUNA-N  
 INSULATOR: POLYAMIDE  
 CONTACTS: COPPER ALLOY WITH GOLD PLATING

DIN 43650 I. S. B. PIN #	M12 (MDC) 4 POLE PIN #	M12 (MDC) 5 POLE PIN #
1	4	4
2	3	3
GND	NOT USED	5
	1,2 & 5 (NOT USED)	1 & 2 (NOT USED)

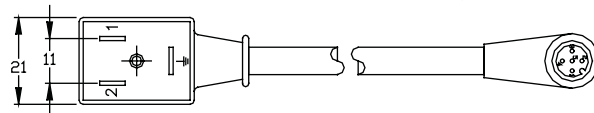
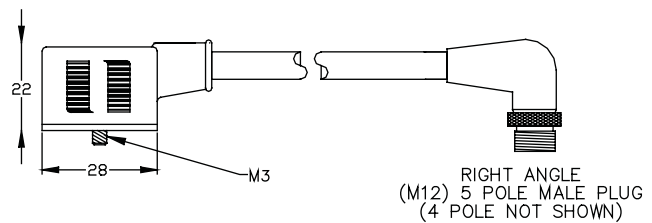
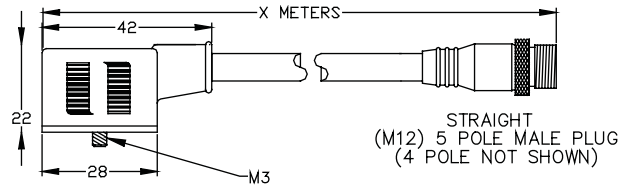

<b>SOLENOID VALVE CONNECTORS</b>	<b>DIN 43650 C TO MICRO DC MALE CABLE</b>	<b>DIN 43650 FORM C TO MDC</b>
----------------------------------	---	--------------------------------

# OF POLES	VOLTAGE	CIRCUITRY	M12 (MDC) 4 POLE CABLE STRAIGHT MALE			M12 (MDC) 4 POLE CABLE RIGHT ANGLE MALE		
			2 METERS	5 METERS	10 METERS	2 METERS	5 METERS	10 METERS
2+ GND	250V AC/DC (MAX)	NONE	VCN-220-3401	VCN-520-3401	VCN-A20-3401	VCN-220-3402	VCN-520-3402	VCN-A20-3402
2+ GND	10-50V DC	LED W/ FLYBACK DIODE	VCC-220-3401	VCC-520-3401	VCC-A20-3401	VCC-220-3402	VCC-520-3402	VCC-A20-3402
2+ GND	120V AC/DC	LED W/ MOV	VCJ-220-3401	VCJ-520-3401	VCJ-A20-3401	VCJ-220-3402	VCJ-520-3402	VCJ-A20-3402

# OF POLES	VOLTAGE	CIRCUITRY	M12 (MDC) 5 POLE CABLE STRAIGHT MALE			M12 (MDC) 5 POLE CABLE RIGHT ANGLE MALE		
			2 METERS	5 METERS	10 METERS	2 METERS	5 METERS	10 METERS
2+ GND	250V AC/DC (MAX)	NONE	VCN-220-3501	VCN-520-3501	VCN-A20-3501	VCN-220-3502	VCN-520-3502	VCN-A20-3502
2+ GND	10-50V DC	LED W/ FLYBACK DIODE	VCC-220-3501	VCC-520-3501	VCC-A20-3501	VCC-220-3502	VCC-520-3502	VCC-A20-3502
2+ GND	120V AC/DC	LED W/ MOV	VCJ-220-3501	VCJ-520-3501	VCJ-A20-3501	VCJ-220-3502	VCJ-520-3502	VCJ-A20-3502

**DIN CONNECTOR MATERIALS:**

BODY: POLYAMIDE  
 CONTACT: COPPER ALLOY SILVER PLATED  
 GASKET: THERMOPLASTIC  
 SCREW: STEEL ZINC PLATE  
 TEMPERATURE: -40°C TO +80°C  
 PROTECTION: IP 65

**MDC CONNECTOR MATERIALS:**

BODY: NICKEL PLATED BRASS  
 O-RING: BUNA-N  
 INSULATOR: POLYAMIDE  
 CONTACTS: COPPER ALLOY WITH GOLD PLATING

DIN 43650 FORM C PIN #	M12 (MDC) 4 POLE PIN #	M12 (MDC) 5 POLE PIN #
1	4	4
2	3	3
GND	NOT USED	5
	1,2 & 5 (NOT USED)	1 & 2 (NOT USED)

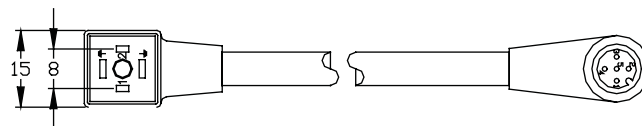
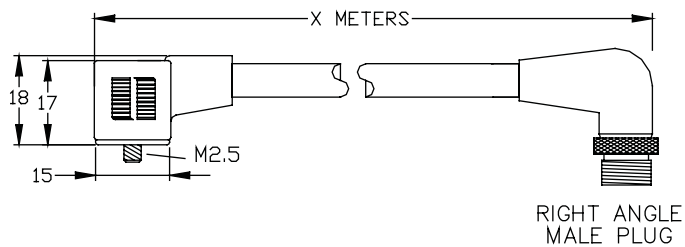
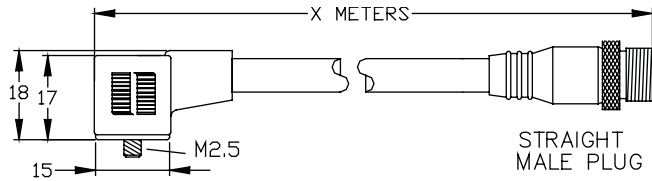

<b>SOLENOID VALVE CONNECTORS</b>	<b>IND. STD C TO MICRO DC MALE CABLE</b>	<b>IND. STD. FORM C TO MDC</b>
--	--	--

# OF POLES	VOLTAGE	CIRCUITRY	M12 (MDC) 4 POLE CABLE STRAIGHT MALE			M12 (MDC) 4 POLE CABLE RIGHT ANGLE MALE		
			2 METERS	5 METERS	10 METERS	2 METERS	5 METERS	10 METERS
2+ GND	250V AC/DC (MAX)	NONE	VEN-220-3401	VEN-520-3401	VEN-A20-3401	VEN-220-3402	VEN-520-3402	VEN-A20-3402
2+ GND	10-50V DC	LED W/ FLYBACK DIODE	VEC-220-3401	VEC-520-3401	VEC-A20-3401	VEC-220-3402	VEC-520-3402	VEC-A20-3402
2+ GND	120V AC/DC	LED W/ MOV	VEJ-220-3401	VEJ-520-3401	VEJ-A20-3401	VEJ-220-3402	VEJ-520-3402	VEJ-A20-3402

# OF POLES	VOLTAGE	CIRCUITRY	M12 (MDC) 5 POLE CABLE STRAIGHT MALE			M12 (MDC) 5 POLE CABLE RIGHT ANGLE MALE		
			2 METERS	5 METERS	10 METERS	2 METERS	5 METERS	10 METERS
2+ GND	250V AC/DC (MAX)	NONE	VEN-220-3501	VEN-520-3501	VEN-A20-3501	VEN-220-3502	VEN-520-3502	VEN-A20-3502
2+ GND	10-50V DC	LED W/ FLYBACK DIODE	VEC-220-3501	VEC-520-3501	VEC-A20-3501	VEC-220-3502	VEC-520-3502	VEC-A20-3502
2+ GND	120V AC/DC	LED W/ MOV	VEJ-220-3501	VEJ-520-3501	VEJ-A20-3501	VEJ-220-3502	VEJ-520-3502	VEJ-A20-3502

**MATERIALS:**

BODY: POLYAMIDE  
 CONTACT: COPPER ALLOY SILVER PLATED  
 INSERT: POLYAMIDE  
 OVERMOLD: PVC

TEMPERATURE: -40°C TO +80°C  
 2 POLE: 3x18 AWG  
 CABLE O.D.: 0.24"  
 PROTECTION: IP 65

**MATERIALS: MDC**

CONNECTOR: OIL RESISTANT PVC BODY, POLYAMIDE CONTACT CARRIER.  
 CONTACTS: COPPER ALLOY WITH GOLD PLATING  
 COUPLING NUT: NICKEL PLATED BRASS.

I.S.C PIN #	M12 (MDC) 4 POLE PIN #	M12 (MDC) 5 POLE PIN #
1	4	4
2	3	3
GND	NOT USED	5
	1,2 & 5 (NOT USED)	1 & 2 (NOT USED)

